



P516-157



RX-LC Switch Retrofit
Retrofit del interruptor RX-LC
Mise à niveau du commutateur RX-LC

Instrucciones de instalación

Installation Instructions

Notice d'installation

- 1** Remove Exit Device from Door
Retire el dispositivo de salida de la puerta
Retirez le dispositif de sortie de la porte

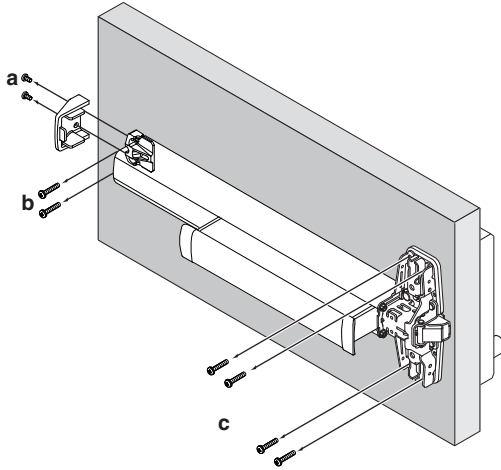

- 2** Remove Mechanism Case
Retire la caja del Mecanismo
Retirez le boîtier du mécanisme

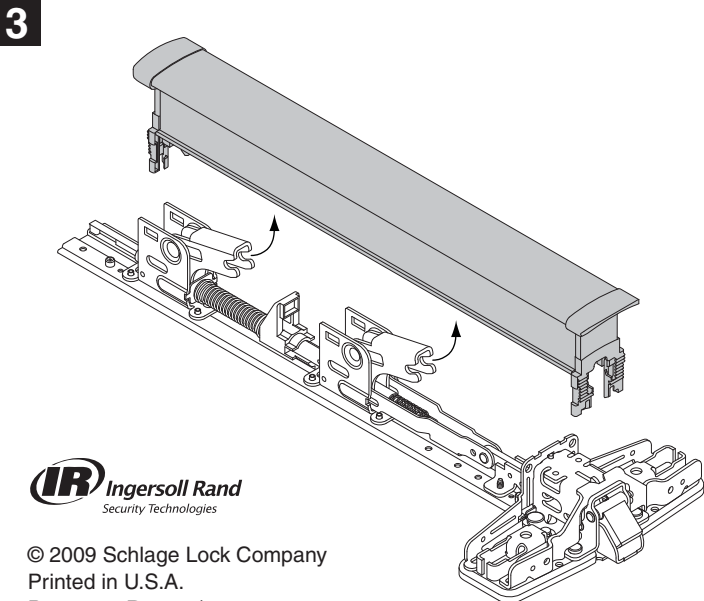
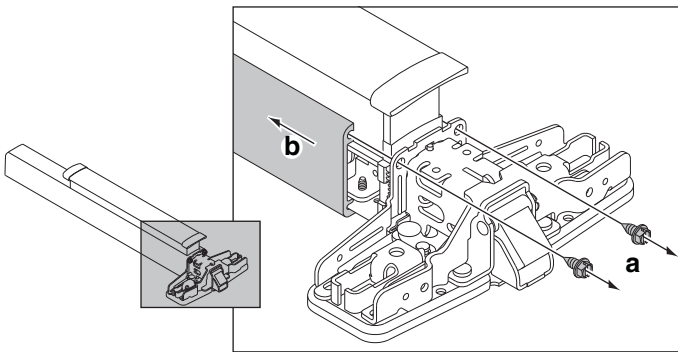

- 4** Clip Off Yellow Wire from New RX Switch
Separe el alambre amarillo del nuevo interruptor RX
Coupez le fil jaune du nouveau commutateur RX

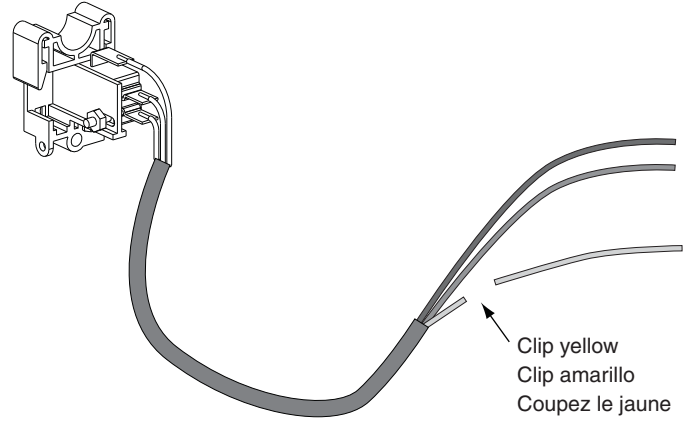

- 5** Install New Switch
Instale el nuevo interruptor
Installez le nouveau commutateur

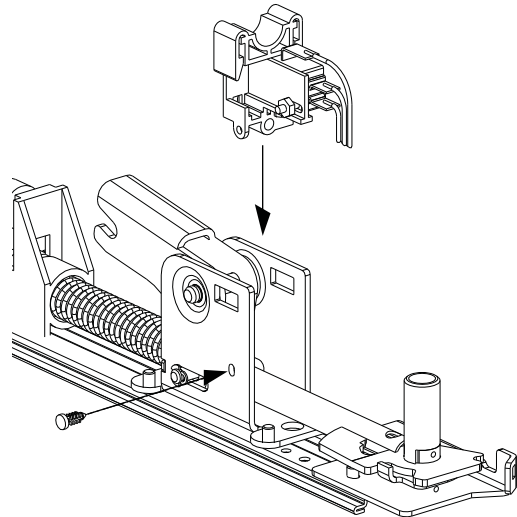

- 6** Route Wires through Hole and Secure with Tie
Enrute los cables a través del orificio y asegúrelos con un amarre
Alimentez les fils à travers l'orifice et fixez à l'aide d'une attache autobloquante

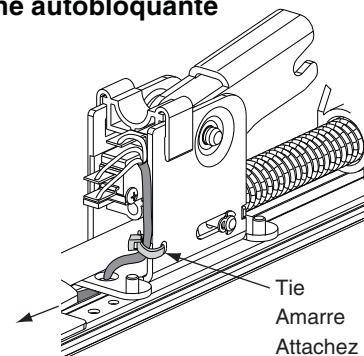

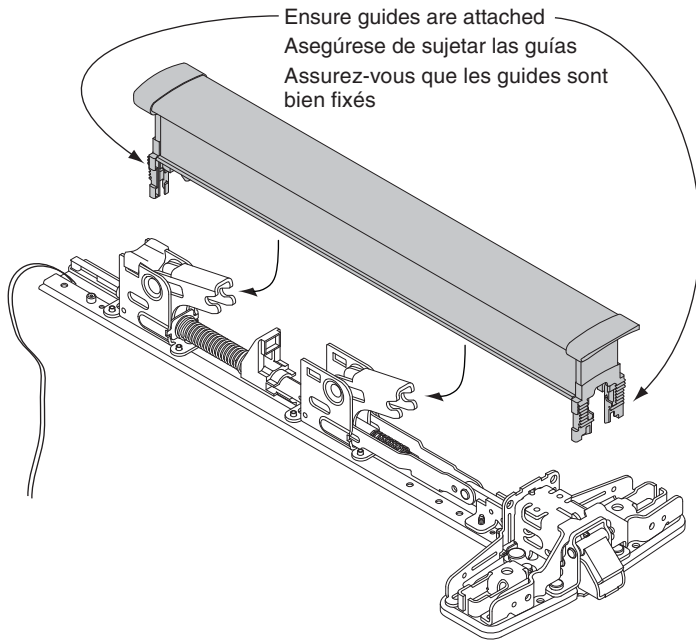
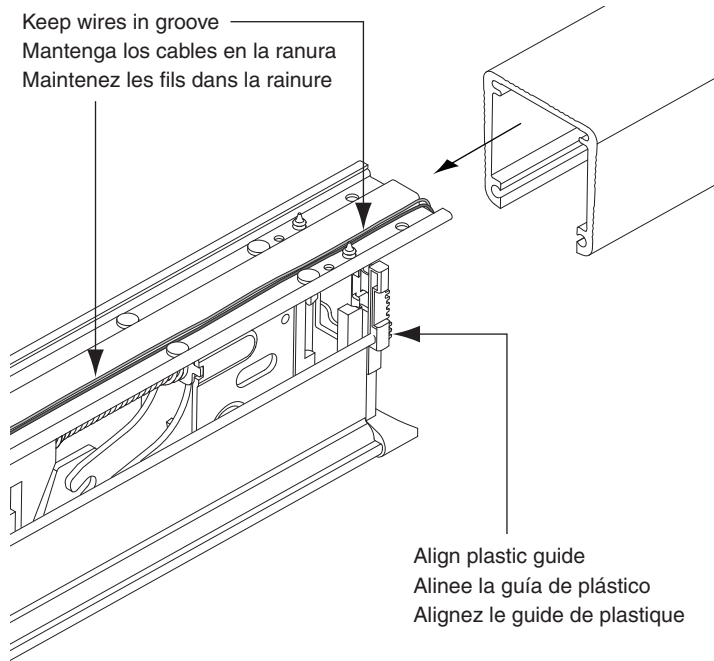
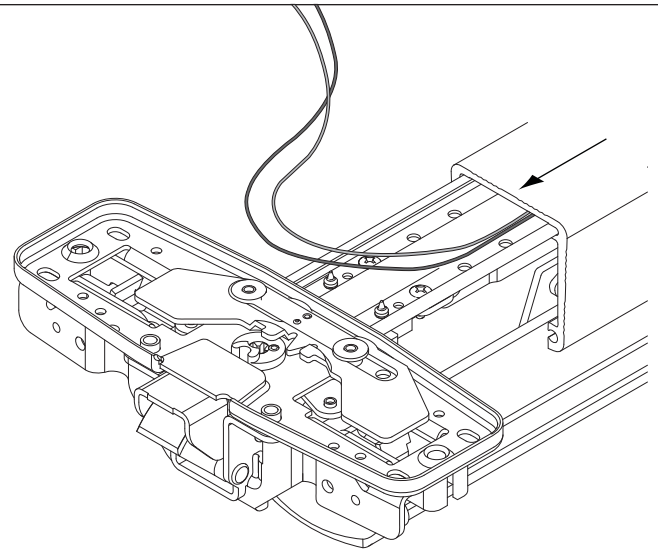
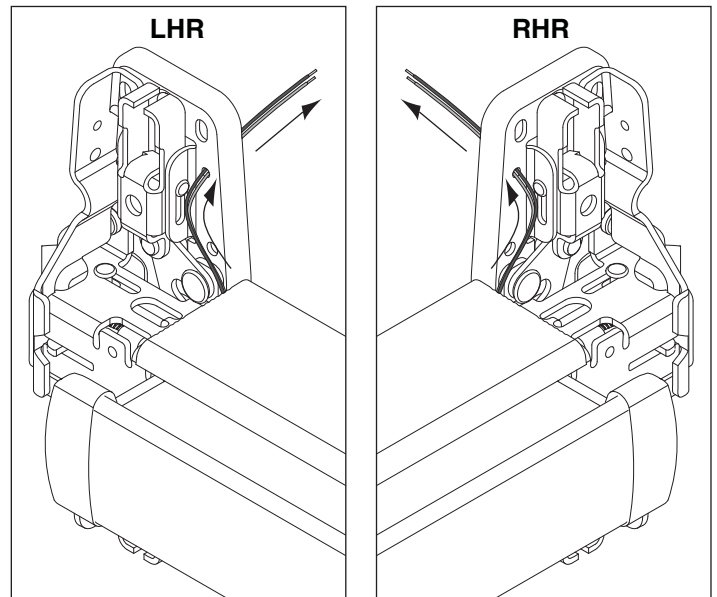
7**Install Pushbar****Instale la barra de empuje****Installez la barre de poussée****8****Place wires in bottom groove, and slide case on****Coloque los cables en la ranura inferior y coloque la cubierta deslizándola****Placez les fils dans la rainure du bas et faites glisser le boîtier par-dessus****9****10****Route Wires through Hole****Enrute los cables a través del orificio****Alimentez les fils à travers l'orifice****11****Reattach Mechanism Case****Vuelva a sujetar la cubierta del mecanismo****Rattachez le boîtier du mécanisme**